



8 Tm compact spindle pullers

Manual

1010H



1108H



1308TH



INDEX

1. 8 Tm spindle 3
2. 1010H puller 4
3. 1108H puller 5
4. 2 and 3 jaws puller 7
5. User instructions 8
6. Transformation 9
7. Pullers set 10

Revisión 6 - 09.03.2021

FORZA FORZA FORZA FORZA FORZA FORZA FORZA FORZA FORZA FORZA

■ 1. 8Tm SPINDLE

15000E STROKE = 10mm

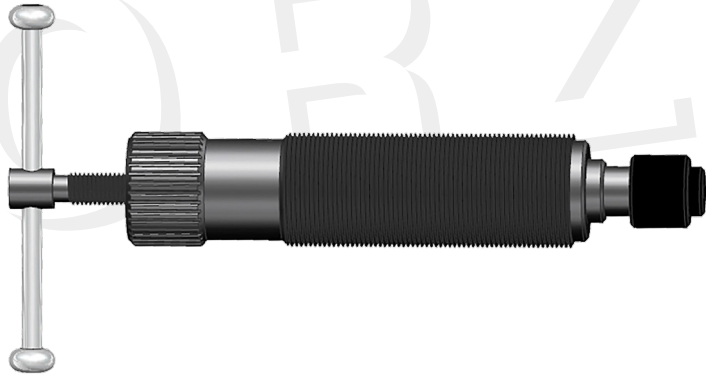

Is the compact hydraulic spindle.

The handle has the proper length to make 8ton with a moderate effort. DO NOT levers, or levers in order to make more force du to the handle will bend and the cylinder will be broken.

USER INSTRUCTIONS

1. Follow the instructions for assembling the puller.
2. Push the spindle while turning manually the knurled area in order to make mechanical pressure. In this way the piston returns.
3. turn the handle to apply hidraulic pressure.
4. Follow the security instructions on page 8.

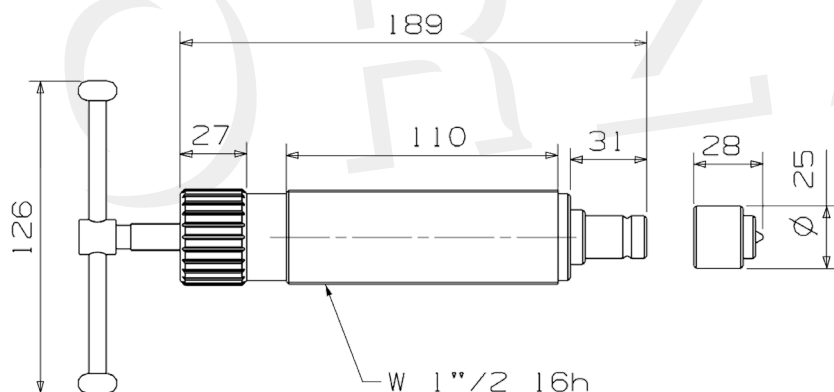

2. 1010H PULLER.

Technical features

- 2 jaws puller
- External and Internal.
- Fixed jaws

2-1. Pullers dimensions

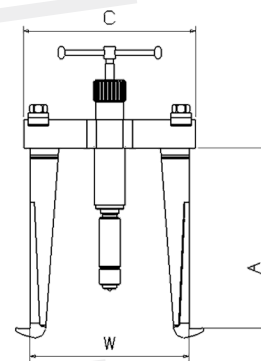
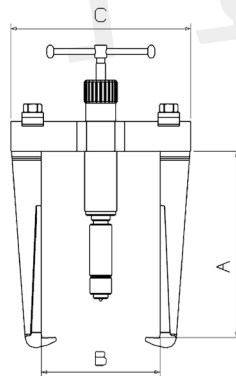

Reference	A	B Max.	B Min.	W Max.	W Min.	C	Ton.	Weight
1010H	160	150	60	215	172	210	8	4,8
1010HL	220	150	60	215	172	210	8	5,5
1010AH	160	200	60	270	172	260	8	5,1
1010LAH	220	200	60	270	172	260	8	5,8

2-1. Mechanical spare parts

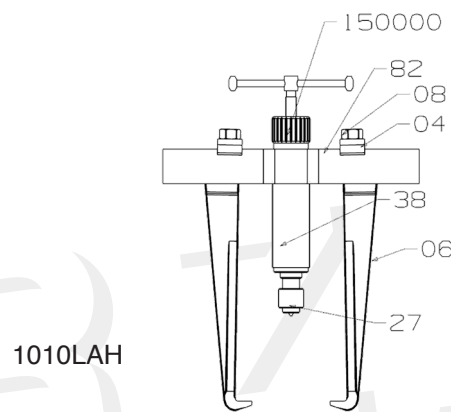
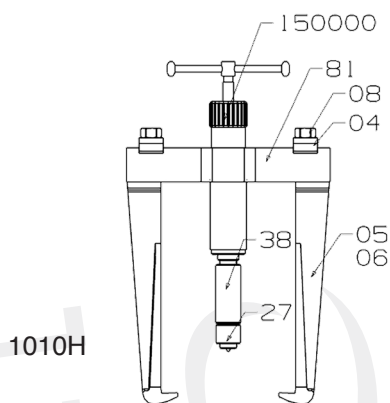

The four models are mounted:

With two bodies: 101081 for the normal puller and 101082 for the A pullers.

Two legs 101005 for the normal puller and 101006 for the L puller.

The L pullers have two extensions n°38.

3. 1108H PULLER.

Technical features

2 jaws puller.

It combines with 1204B and 1206B splitters.

3.1 Puller dimensions

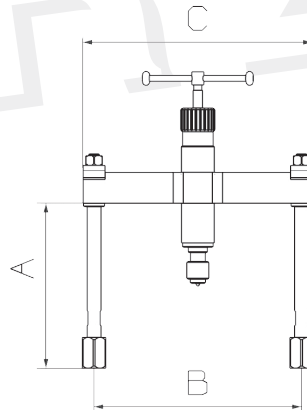

Reference	A	B	C	Peso
1108H	190	200	210	4,8
1108AH	190	250	260	4,6

2-1. Spare parts

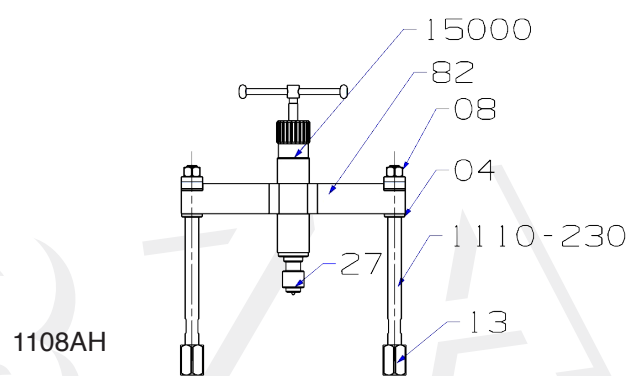
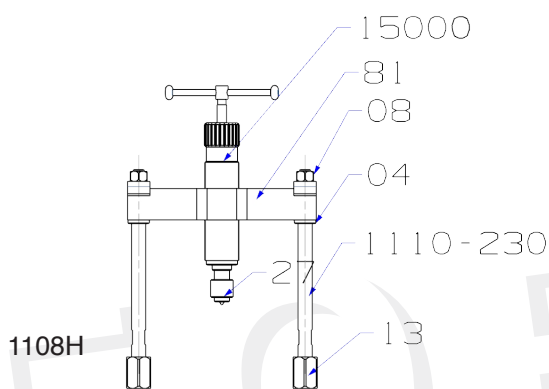

Both bodies are 101081 for normal puller, and 101082 for A puller.

The 38 part (101038) is an extension for the hydraulic spindle.

3. 1200 splitter serie combine.

1108h pullers combine with 1200 series:

As a measure of the pulley to be extracted, do not take the splitter minimum dimension B, but the $\varnothing C$, which is the distance between the extenders.

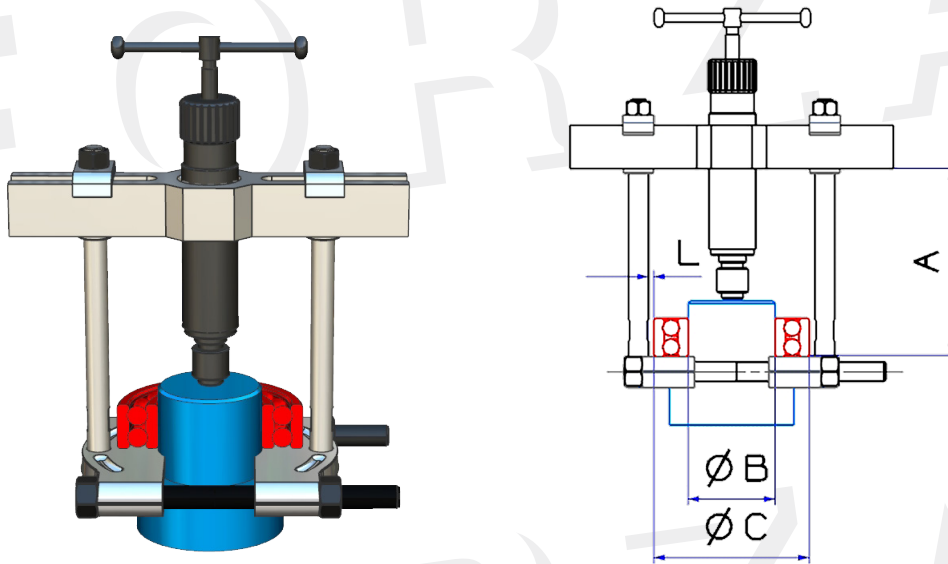

Reference	A	B	C
1108H - 1204B	152	105	170
1108AH - 1204B	152	105	175
1108AH - 1206B	152	105	222

Correct assembly of splitters.

The 1200 puller must be supported on the flat side.

The extenders shall be as close as possible to the part to be extracted.

That is to say, the distance L it is as small as possible.

Incorrect assembly of splitters.

The 1200 puller is not supported on the flat side.

The extenders are very far from the part to be extracted. That is to say, the distance L is very large.

In this position the torque on the extender tip is multiplied by L.

In this position, the maximum tension CAN NOT be reached. Watch the deflection of the splitter spindles and stop when you see it too big.

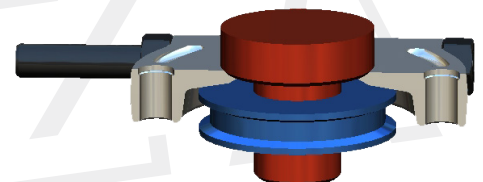

4. 2 AND 3 JAWS PULLER

Téchnical features

2 and 3 forged jaws puller.

4.1 1308TH PULLER

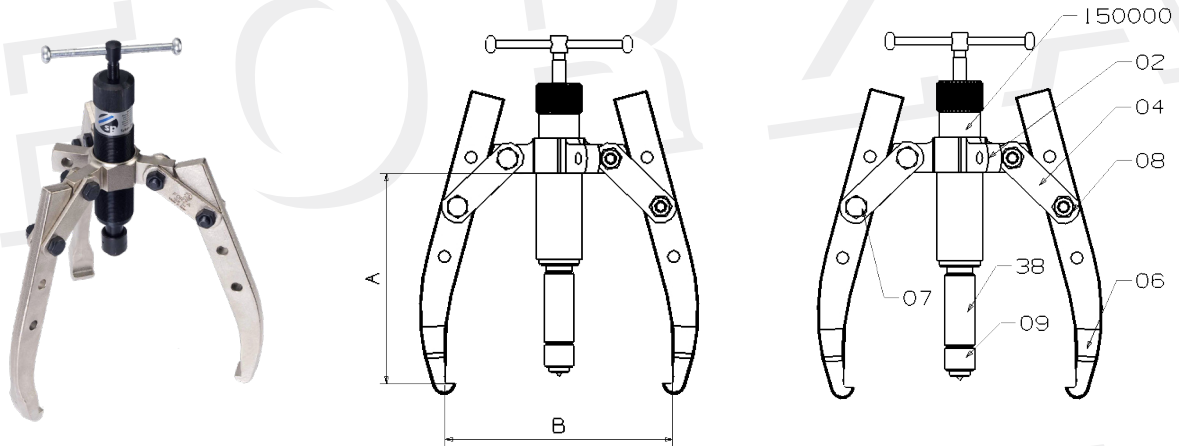

Reference	A	B	Ton.	Weigth
1308TH	225	260	8	4,5

4.2 1308THA PULLER

2 and 3 forged jaws selfcentering puller.

All the jaws move simultaneously. The selfcentering puller is very safe because it cannot be opened more than its suitable use allows.

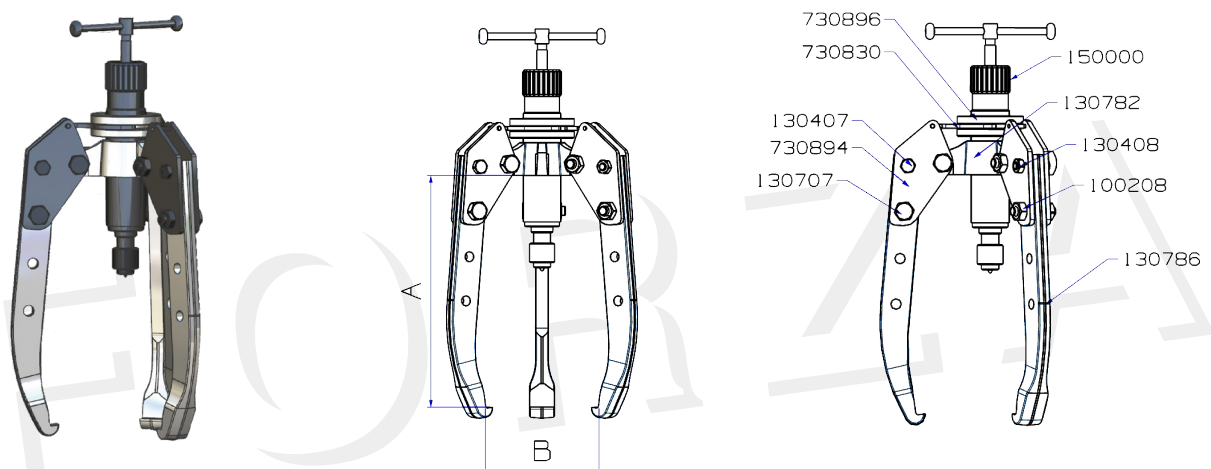

Reference	A	B	Ton.	Weigth
1308THA	225	260	8	7,5

4-3. 7308ALTH PULLER

2 and 3 forged jaws selfcentering puller.

Jaws with very thin section and slotted to pull out screws.

All the jaws move simultaneously. The selfcentering puller is very safe because it cannot be opened more than its suitable use allows.

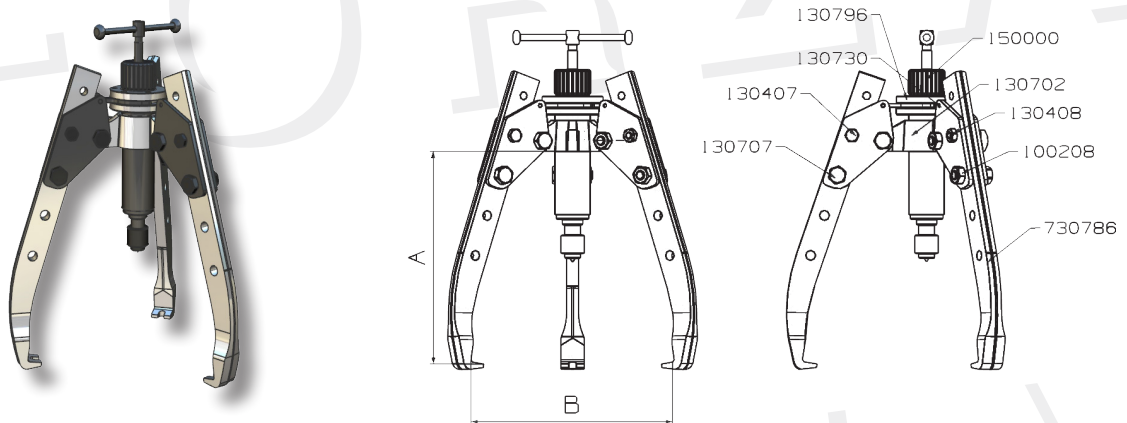

Reference	A	B	Ton.	Weigth
7308ALTH	270	280	8	7,5

5. USER INSTRUCTIONS



- 1-Make sure that the extender or the jaws are well centered.
- 2- Use all the necessary personal protective equipment (PPE).
- 3- The force is made by the hydraulic spindle.

DO NOT USE POWER TOOLS

6. TRANSFORMATION

All the 8 ton pullers can become into hydraulic cylinder 5 ton pullers. It is only necessary to change the hydraulic cylinder by the compact spindle 150000E.



00904

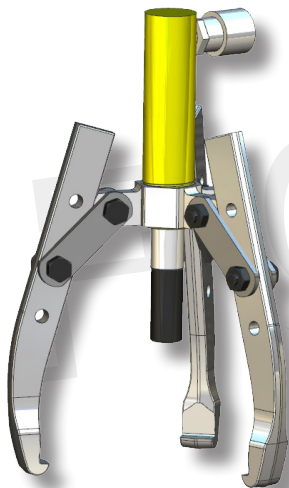

1307LTH

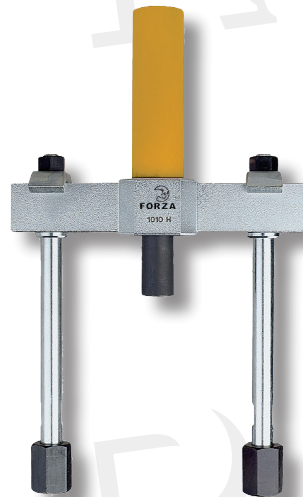

1108HF

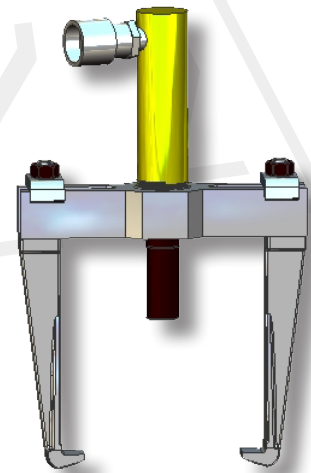

1010HF

■ 6. C. PULLERS SET

6.1 C1004 PULLERS SET.

Contains the following parts.



The following pullers can be mounted:



6.2 C1005 PULLERS SET.

Contains the following parts.



C1005

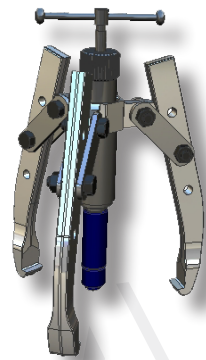

1308TH

The following pullers can be mounted:

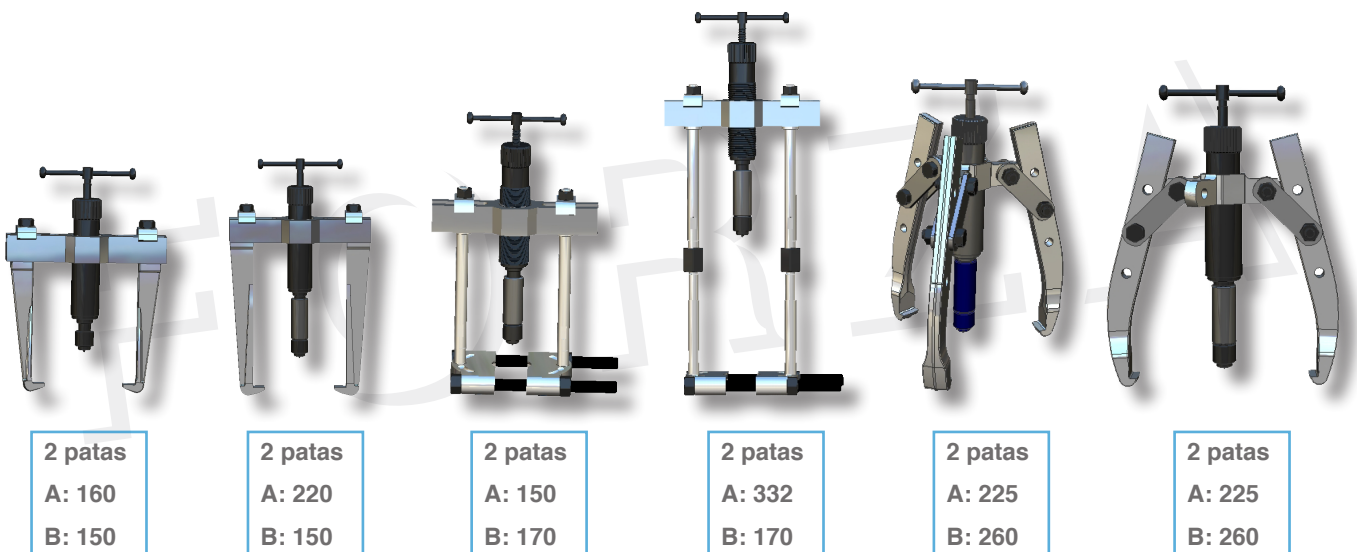

6.3 C1006 PULLERS SET.

Contains the following parts

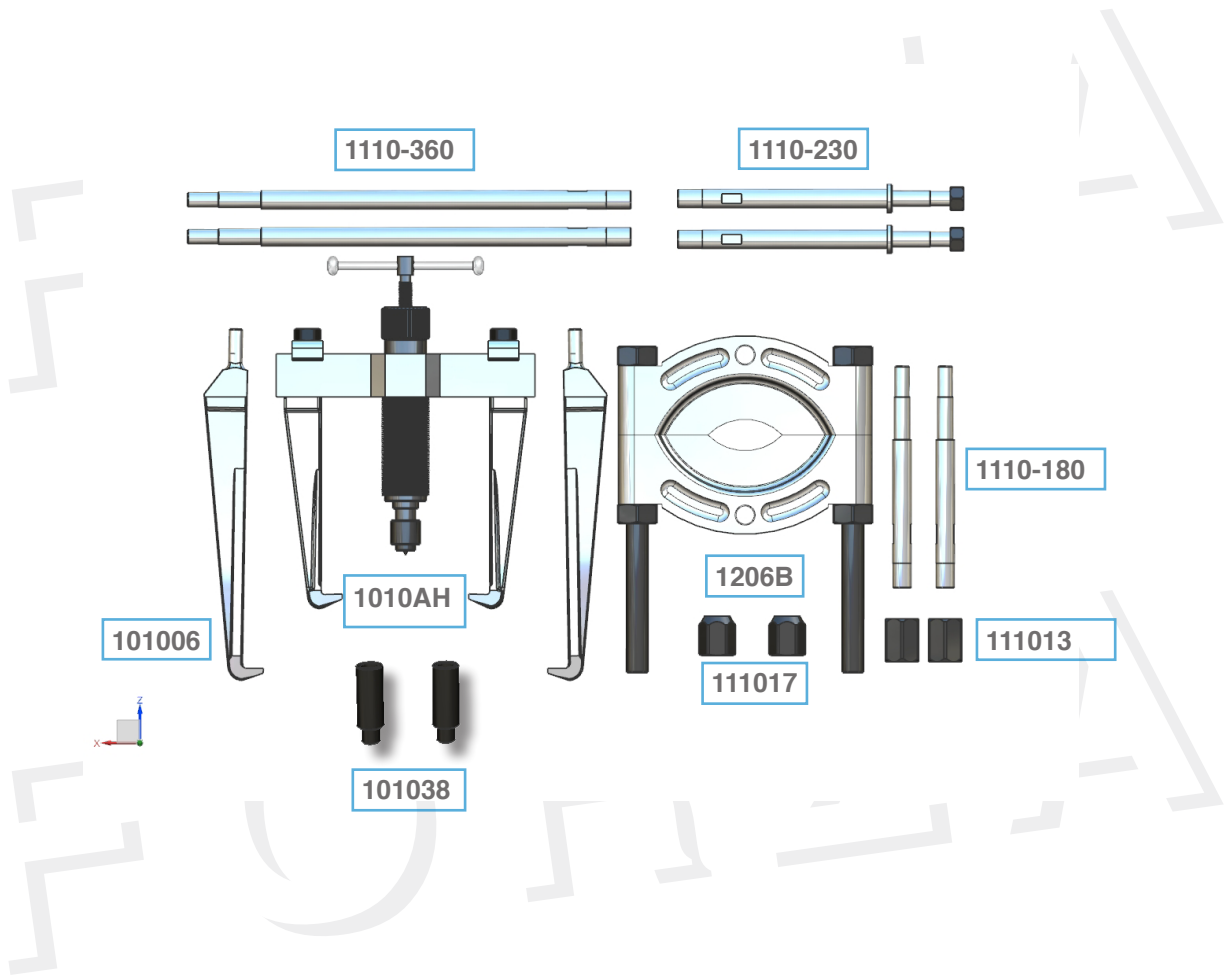

The following pullers can be mounted:

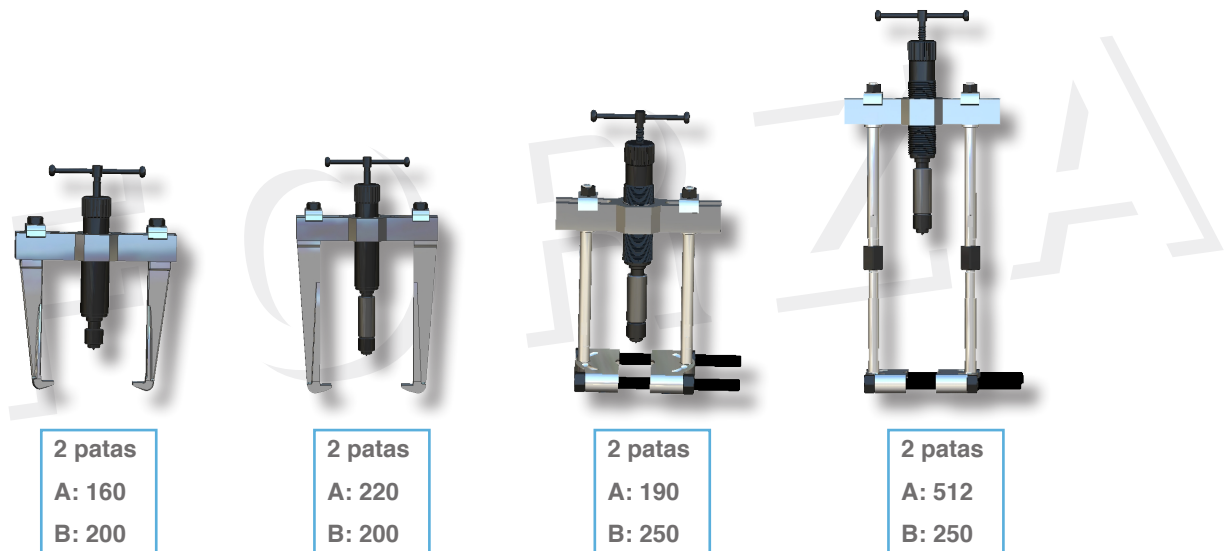



S.L. de Herramientas Especiales Forza

C/ San Miguel de Atxa, 24

01010 Vitoria

www.forza.es
